

Nine figure	360900060	Status	OK	Type	SCN (GDA), Est. AHD
Easting	384566.692	Northing	5791508.397	AHD height	352.8 Zone 55
Latitude	-38° 01' 00.3707"	Longitude	145° 41' 05.8500"	Ellipsoid height	358.4 CSF 0.9997088
H _z uncertainty	0.020	H _z order	3	V _t uncertainty	V _t order 5
Plan ref		Datum	GDA2020		

SEC. 6 (1) (c) SURVEY CO-ORDINATION ACT 1958

PERMANENT MARK SKETCH PLAN

Township _____ Parish TONIMBUK EAST

- NOTE:— Not necessarily to Scale
- (1) Measurements to be shown from the Permanent Mark to as many near-by survey marks, buildings, fence posts, hydrants, trees, etc., as practicable. Up to six such measurements are desirable.
 - (2) Except where verified by a Licensed Surveyor in this survey, all boundaries in this sketch plan are to be shown by broken lines. The symbols for fences, buildings, etc., to be shown on the broken lines.
 - (3) Description of Permanent Mark and, where possible, Crown Abuttals are to be shown.

A.M.G. CO ORDINATES
SCALED FROM—
MAP NAME:
SCALE:
ZONE: E 384 454.219
N5791 322.787

MEASUREMENTS ARE IN METRES

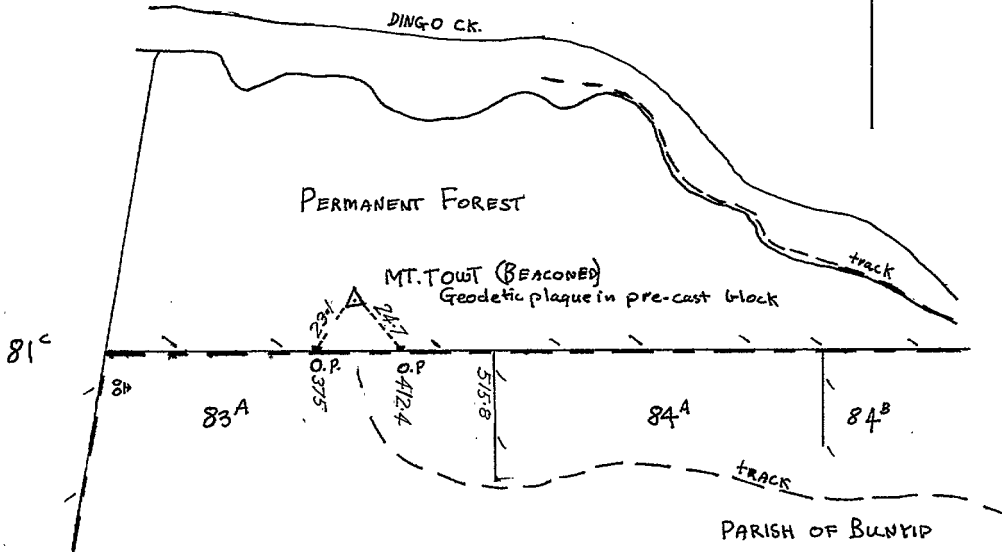

Established in connection with * GEODETIC SURVEY Ref. No. 55007

IF LEVELLED:— Reduced level of Mark _____ to Datum †
†e.g. Railways, Board of Works, Sewerage Authority, etc., or Arbitrary

I certify that the Permanent Mark shown in this sketch have been established on the ground by me in accordance with the Regulations under the Survey Co-ordination Act 1958 and that the information shown hereon is correct.

Department or Authority LANDS AND SURVEY Signature [Signature] †
 Date 18-3-1980

‡ If a Licensed Surveyor the Letters L.S. to be added

TO BE FILLED IN BY THE CENTRAL PLAN OFFICE

Zone	Square	Subdivision	Same Datum R.L.	Number
			R.L. Copied from	6

Noted on Record Plan T.285 (10) C4 9.1.81

MT. TOWT TRIG. 55007

T.O. Shire of Berwick S.R. & W S C. Geo.Sec. ✓
 Forest

19 MAR 1980