



Nine figure	327904900	Status	OK	Type	SCN (GDA), Est. AHD
Easting	355920.533	Northing	5795819.660	AHD height	177.54 Zone 55
Latitude	-37° 58' 25.7767"	Longitude	145° 21' 34.5301"	Ellipsoid height	182.60 CSF 0.9998278
Hx uncertainty	0.017	Hx order	3	Vt uncertainty	Vt order
Plan ref		Datum	GDA2020		

SEC. 6(1)(C) SURVEY CO-ORDINATION ACT 1958  
 ORIGINAL / ~~SUPPLEMENTARY~~ \*  
 PERMANENT MARK SKETCH PLAN

\* Delete as Appropriate

Township ..... Parish NARREE WORRAN

- NOTES: (1) Connections to be shown to buildings, fences, poles, survey marks or nearby monuments.  
 (2) Unless verified by a Licensed Surveyor, all cadastral boundaries are to be shown by broken lines.  
 (3) Connection should be shown to nearest Crown allotment or named street or road.  
 (4) Plan need not be to scale: lengths shown to be in METRES.

Description of Permanent Mark GEODETTIC TRIANGULATION PLAQUE & ARMY QUAD BEACON  
 Existence of box-cover: ~~Yes~~ / No Marker post: ~~Yes~~ / No

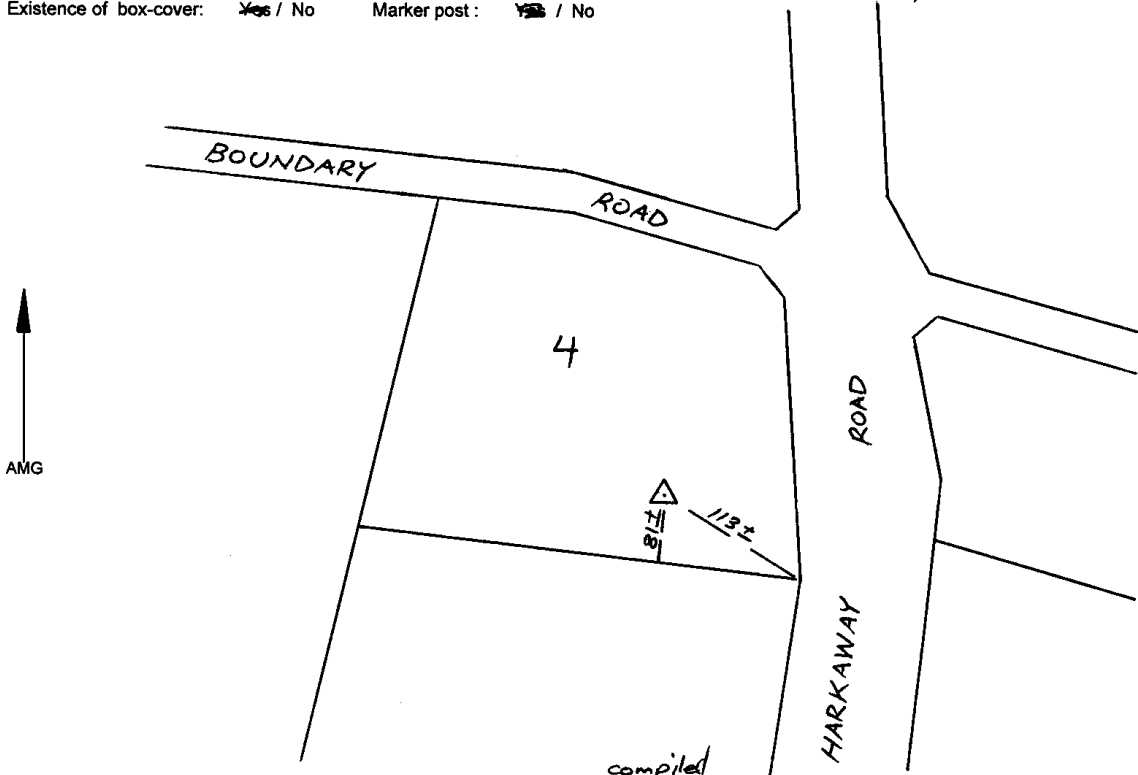

I certify that the Permanent Mark shown in this sketch has been ~~established~~ <sup>compiled</sup> ~~found on the ground~~ by me in accordance with the Regulations under the Survey Co-ordination Act 1958, and that the information shown hereon is correct.

GLEN ROWAN NORTH 1982

Company or Agency Reference No. 82107 Surname P. GROWSE Signature Pete Crown \*

Company or Agency: LAND VICTORIA SURVEY Date 10 / 9 / 02

Municipality ..... \*If a Licensed Surveyor the letter LS to be added.  
 If a Registered Surveyor the letter RS to be added.

AMG REFERENCE CO-ORDINATES  
 (May be scaled to nearest 100 metres)

MAP SHEET: .....

SCALE: ..... ZONE: 55

E 355808

N 5795634

If in Melbourne Metropolitan area  
 Melway Ref. 109G4

OFFICE USE ONLY		
Date Rec'd	REGISTERED SURVEYS CONNECTED TO THIS PM	PARISH NUMBER
12 SEP 2002		490

**490**