

| | | | | | |
|----------------------------|-------------------|----------------------|-------------------|----------------------------|------------------------|
| Nine figure | 388500290 | Status | OK | Type | SCN (GDA), Est. AHD |
| Easting | 439692.273 | Northing | 5730646.004 | AHD height | 581.4 Zone 55 |
| Latitude | -38° 34' 14.1428" | Longitude | 146° 18' 27.7500" | Ellipsoid height | 586.0 CSF 0.9995536 |
| H _z uncertainty | 0.003 | H _z order | 3 | V _t uncertainty | V _t order 5 |
| Plan ref | | Datum | GDA2020 | | |

A.J.

SEC. 6 (1) (c) SURVEY CO-ORDINATION ACT 1958

PERMANENT MARK SKETCH PLAN

Township _____ Parish WOORARRA

Not necessarily to Scale

NOTE

- (1) Connections to be shown to buildings, fences, poles, survey marks or monuments nearby.
- (2) Unless verified by a licensed surveyor, all boundaries are to be shown by broken lines.
- (3) Connection should be shown to nearest Crown allotment boundary or named street or road.

Description of Permanent Mark GEODETIC SURVEY PLAQUE SET IN CONCRETE

Existence of box-cover NONE marker post QUAD BEACON

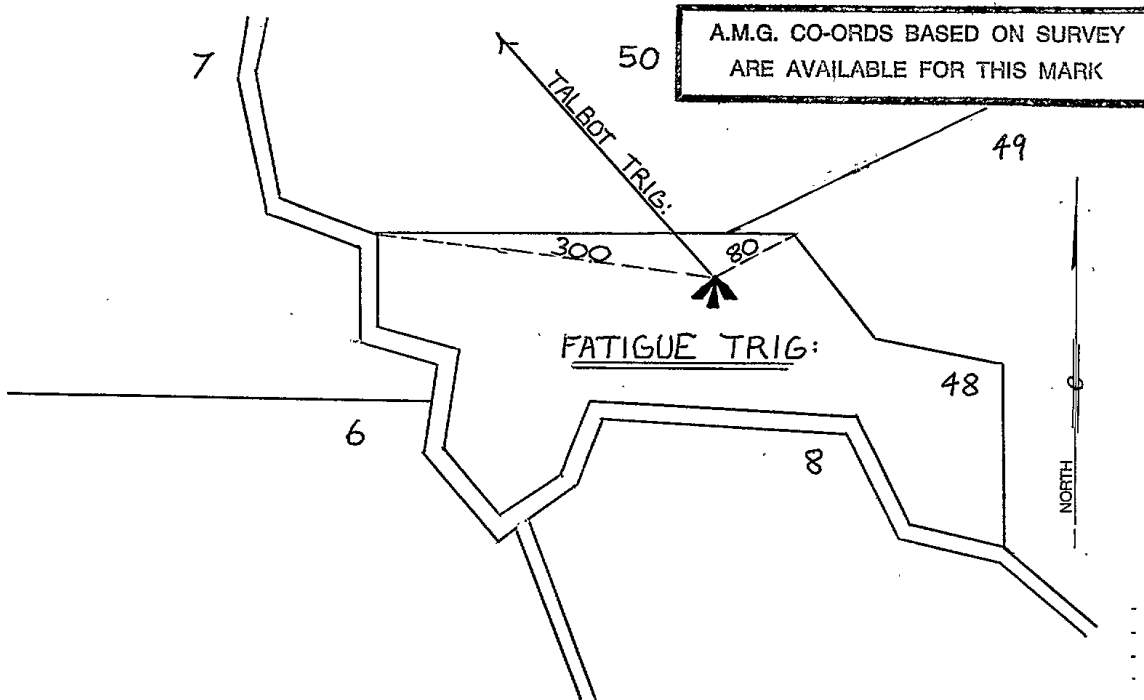

MEASUREMENTS ARE IN METRES SCALED ± 20 M.

I certify that the Permanent Mark shown in this sketch has been ~~established on the ground~~ ^{COMPILED} by me in accordance with the Regulations under the Survey Co-ordination Act 1958 and that the information shown hereon is correct.

Department of Authority CROWN LANDS AND SURVEY Signature Peter Mats *

Authority's Reference or Designated No. 00093 Date 30 JUNE 1983

Municipality SOUTH GIPPSLAND * If a Licensed Surveyor the Letters L.S. to be added
* If a Registered Surveyor the Letters R.S. to be added.

| | | |
|--|---------------------------|-------------------|
| A.M.G. REFERENCE CO-ORDINATES. (Nearest 100 metre) (May be scaled from 1:100,000 map) - 1 APR 1982 ZONE <u>55</u> E. <u>439 570</u> N. <u>5730 460</u> | TO BE FILLED IN BY C.P.O. | |
| | REGISTERED SURVEYS. | REGISTERED NUMBER |
| CONNECTED | PARISH | |
| | 29 | |
| | FATIGUE TRIG. 00093 | |